

8	7	6	5	4	3	2	1				
CATALOG NO.	CONDUCTOR CODE (AWG)	BOLT SIZE	B	C	E	K	L	N	DD	T (REF)	Y MIN.
HGBL500DB	500Kcmil	3/8 [M10]	2.25 [57]	1.55 [39]	1.00[25]	.40 [10]	4.85 [123]	.41 [10]	1.06 [27]	.23 [6]	1.43 [36]

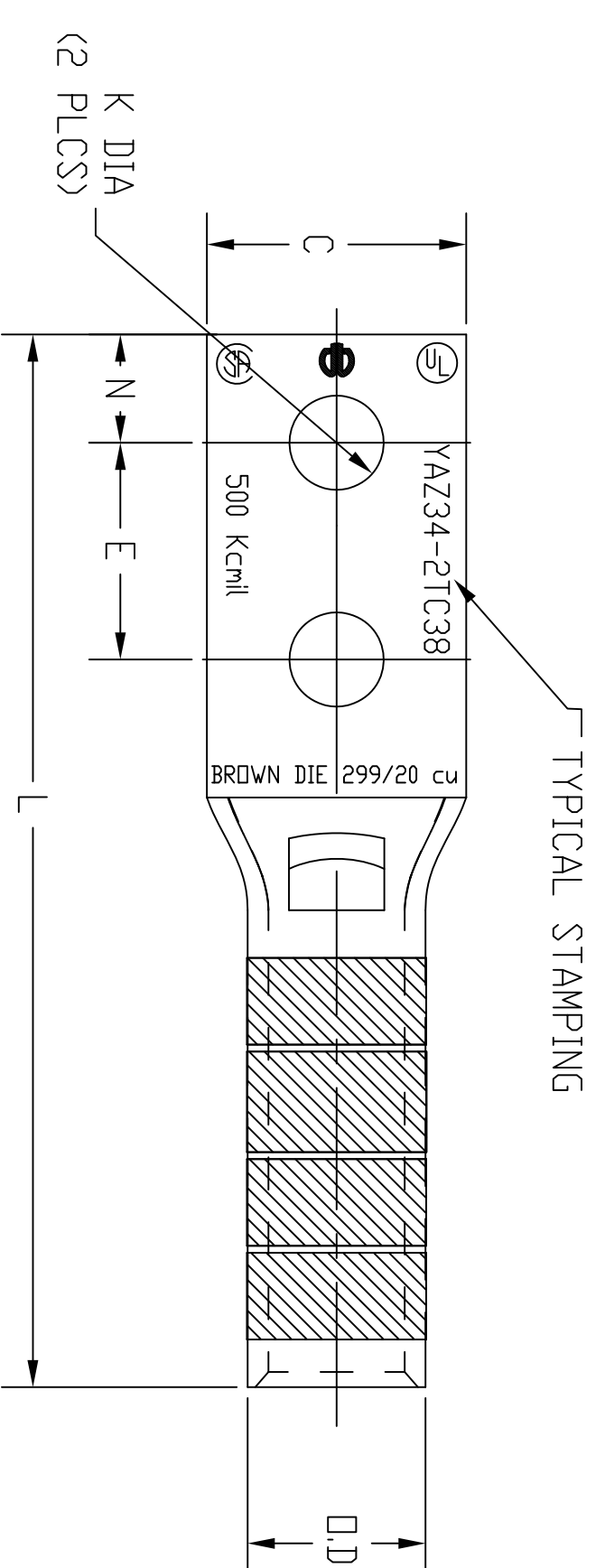

- NOTES:
1. MATERIAL: COPPER TUBING.
 2. FINISH: TIN PLATED
 3. INSTALLATION TOOLING:
MECHANICAL DIE: HW34VT
HYDRAULIC DIE: HU34RT
WIRE STRIP LENGTH: 2-5/16
 4. SPECIFICATIONS SUBJECT TO CHANGE WITHOUT NOTICE.

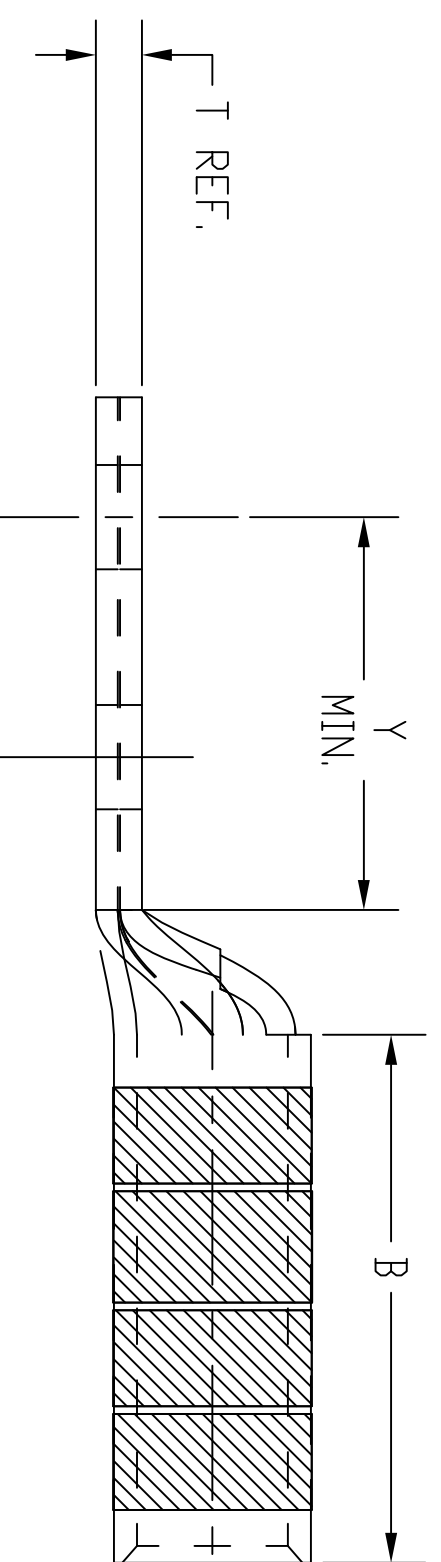

1	18075	01/25/13	INITIAL RELEASE	MMA	
REV.	ECN	DATE	DESCRIPTION	CHG BY	APPD BY

Created on AUTOCAD		DIMENSIONING AND TOLERANCE PER ANSI Y14.5M-1982 UNLESS OTHERWISE SPECIFIED, DIMENSIONS ARE IN INCHES (MM). TOLERANCES .XX = ±.01 (.25) .XXX = ±.005 (.125) .XXXX = ±.002 (.050) ANGLE TO .1°	
PROJECT REFERENCE: 2011-041		HUBBELL Hubbell Premise Wiring HUBBELL INCORPORATED (Delaware) 14 Lord's Hill Road, Stoughton, Connecticut 06378	
MATERIAL: SEE NOTES		TITLE: 500Kcmil COPPER COMPRESSION LUG DOUBLE HOLE, 0.375" HOLE SIZE	
DRAWN BY: M. ABBY 01/23/13		SIZE: DRAWING NO. D HWS777150C	
CHECKED BY:		SCALE: 1/1	
APPROVED BY:		SHEET 1 OF 1	
		REV. 1	